

SEISMIC UNEQUAL FLANGE EQUIPMENT RACK (SUFER)

Modified:09/22/2009

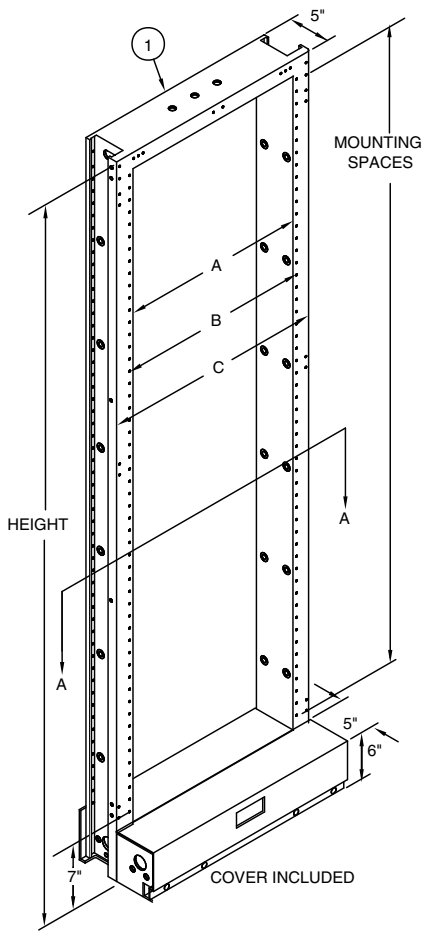

Closed Sufer
(Guard Box On Wide Flange)

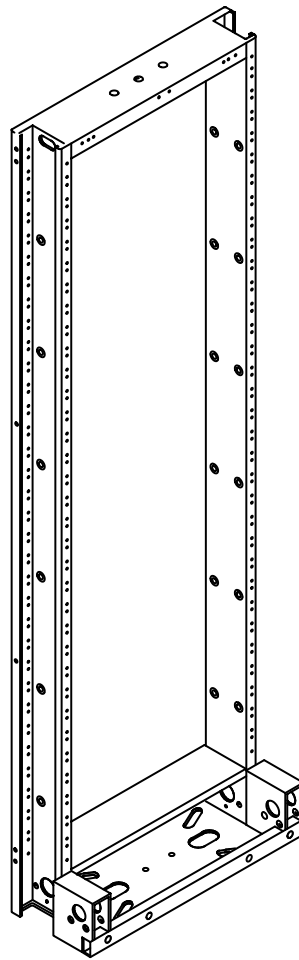

Open Sufer
(Guard Box On Narrow Flange)

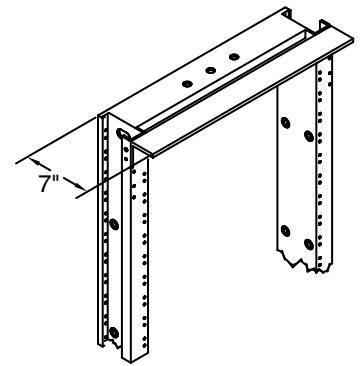

Top Angle On Closed Sufer

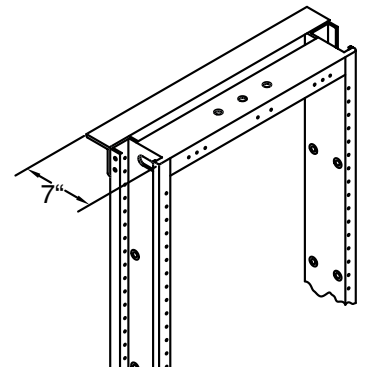

Top Angle On Open Sufer
(Top Angle On Wide Flange)

width	A	B	C	D	E	F
23"	21-1/2"	22-5/16"	25-15/16"	15-5/8"	17-1/4"	25-15/16"
19"	17-1/2"	18-5/16"	21-15/16"	11-5/8"	13-1/4"	21-15/16"

Mounting Panels	Height	Top Angle	1"	2"	1-3/4"
	7'-0"	no	74	37	43
	7'-0"	yes	74	37	42
	7'-6"	no	80	40	46
	8'-0"	yes	86	43	49
	9'-0"	yes	98	49	56
11'-6"	yes	128	64	73	

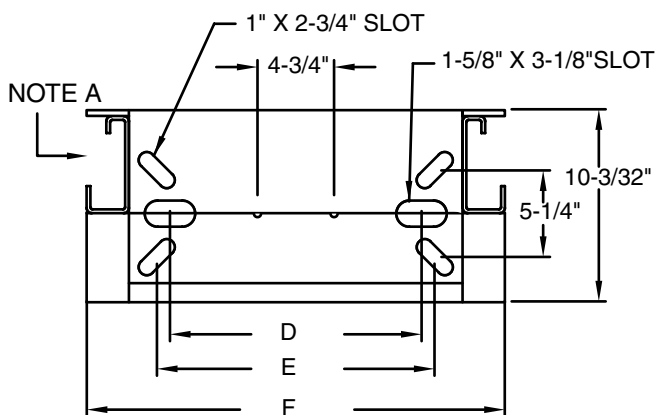

- Follow the steps below to complete your 10 Character ordering number

0046010131 • (Part number below gives you a 7'-0" x 23" closed duct unequal flange equipment rack with 1" spacing with out top angle painted gray).

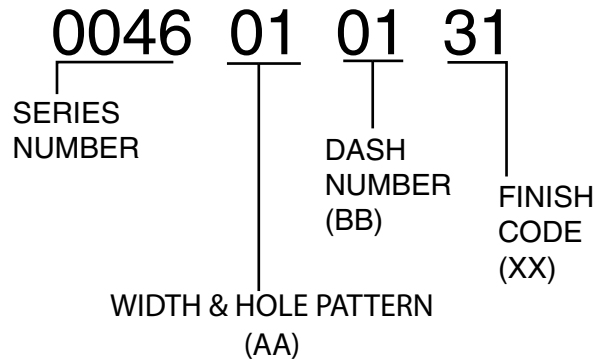

- STEP 1** • Choose AA number for rack according to width, hole pattern and open or closed duct.
- STEP 2** • Choose BB number for rack according to height, top angle configuration.
- To order rack only choose dash number from table B.
 - To order rack with seismic floor mounting kit, call your CSR --(919) 575-6426.
- STEP 3** • The standard finish codes for sufer is "31". Other finishes are available upon request.

0046	AA	BB	XX
0046: SEISMIC UFER	AA: UFER & EQUIPMENT MOUNTING WIDTH 01 = 23" wide; 1" hole pattern; closed duct 02 = 23" wide; 1-3/4" hole pattern; closed duct 03 = 23" wide; 1" hole pattern; open duct 04 = 23" wide; 1-3/4" hole pattern; open duct 05 = 19" wide; 1" hole pattern; closed duct 06 = 19" wide; 1-3/4" hole pattern; closed duct 07 = 19" wide; 1" hole pattern; open duct 08 = 19" wide; 1-3/4" hole pattern; open duct	BB: RACK HEIGHT & TOP ANGLE 01 = 7'- 0" HEIGHT; 11 = 7'- 0" HEIGHT; WITH TOP ANGLE 02 = 7'- 6" HEIGHT; 03 = 8'- 0" HEIGHT; WITH TOP ANGLE 04 = 9'- 0" HEIGHT; WITH TOP ANGLE 05 = 11'- 6" HEIGHT; WITH TOP ANGLE	XX: FINISH CODE 31 = GRAY 30 = TELCO GRAY

Notes:

- Meets the earthquake criteria (seismic Zone 4) of Telcordia document . GR-63-core, issue 1, sections 4.4 And 5.4, When loaded with 500 pounds to simulate rack mounted equipment.
- To order equipment rack only: choose fig. Number from table a in step 1 and the table bin step 2.
- Front and rear of uprights tapped for 12-24 screws
- Cable tie mount kit (p/n 2103180000) is included; separately order cable tie bar kit (fig. 004119) As required. Cable ties (nylon, plastic, etc.) To be customer provided.
- Rack must be secured to concrete floor using seismic floor mounting kit (fig. 004615 Or equivalent). Installing this rack in any other manner may impact load capacity and seismic performance.
- Determine the equipment rack and seismic floor mounting kit desired. The combination of these two determines the dash number from table c in step 2. Refer to fig. 004615 For additional detail.